

# Series MIN800

Miniature Load Cell

## Standard Features

- Small Size
- Tension / Compression
- Welded Stainless Steel
- 0.25% Accuracy
- -65°F to +250°F Operation
- mV/V Output



*Shown Actual Size*

## Standard Specifications

### Performance

<b>Capacities</b>	100, 250, 500, 1000 lbs.
<b>Output</b>	2mV/V nominal.
<b>Accuracy</b>	0.25% BFSL.
<b>Compensated Temperature Range</b>	70°F to 170°F.
<b>Operating Temperature Range</b>	-65°F to 250°F.
<b>Temperature Effect on Zero</b>	0.005% FSO/°F.
<b>Temperature Effect on Span</b>	0.005% Reading/°F.
<b>Zero Balance</b>	3% FSO.
<b>Bridge Resistance</b>	350 Ohms nominal.

### Mechanical Characteristics

<b>Threads</b>	1/4-28 UNF Male (Both Ends).
<b>Calibration</b>	5 Points (0, 50%, 100%, 50%, 0) Tension.
<b>Static Overload Capacity</b>	150% FSO.
<b>Construction</b>	Welded stainless steel.

### Electrical Characteristics

<b>Excitation</b>	10 Vdc or Vac.
<b>Insulation Resistance</b>	Greater than 5000 megaohms at 50 Vdc at 70°F.
<b>Electrical Termination</b>	10', 4 Conductor Shielded Teflon Cable
<b>Wiring</b>	RED +EXE GREEN -SIG BLACK -EXE WHITE +SIG

**MIN800**

# Series MIN800 Specifications

Baseline Configuration Specs Represented.  
Modifications Encouraged - See Below  
Custom Designs Available

## Dimensions (inches)

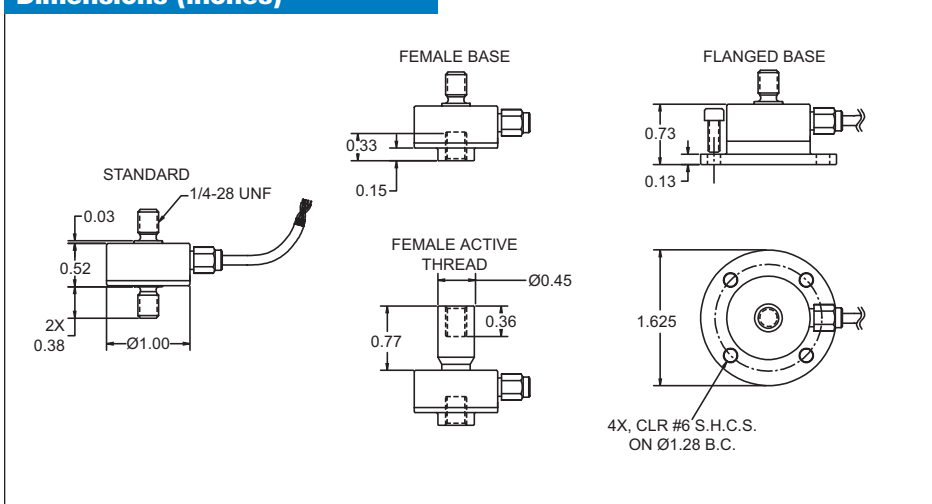

## Available Options

<b>Base</b>	Male (standard). Female. Flange.
<b>Active Thread</b>	Male (standard). Female.
<b>Temperature Compensation Ranges</b>	From -65°F up to 400°F.
<b>Temperature Operating Ranges</b>	From -65°F up to 400°F.
<b>Calibration</b>	Additional calibration points (in addition to standard 5 points) available (Consult Factory) Special and custom calibration available (Consult Factory)
<b>Calibration Type</b>	Compression Only. Tension/Compression.
<b>Amplifiers</b>	Integral or In-Line (Consult Factory). • Analog (4-20 mA; ±5 Vdc; ±10 Vdc). • Digital (RS-232; RS-485; CANbus; MODbus).
<b>Calibration Range</b>	Special full scale range (eg: 75 lb.).
<b>Cable Length</b>	Cable length specified (ft.).
<b>Cable Connector</b>	PT06. MS3102
<b>Custom Options</b>	Other unlisted customer requested options welcome.

CE  
0539

NOTES: When using a load cell the user must consider load ratings and fatigue life for long term use and structural integrity. Critical loading applications, especially overhead loading, must always be designed with safety redundant load paths. MODIFICATIONS: We realize load cell applications vary greatly and as such our designs are flexible. Specifications subject to change without notice.

WARRANTY: Stellar Technology warrants that its product shall be free from defective workmanship and/or material for a twelve month period from the date of shipment, provided that Stellar Technology's obligation hereunder shall be limited to correcting any defective material FOB our factory. No allowance will be made for any expenses incurred for correcting any defective workmanship and/or material without written consent by Stellar Technology. This warranty is in lieu of all other warranties expressed or implied.

Find More Information at:  
[stellartech.com](http://stellartech.com)

Due to the nature of technology, changes are inevitable. For latest technical specifications, see our website.

Copyright © Stellar Technology Incorporated • All Rights Reserved  
Datasheet P/N: 226400B

237 Commerce Drive • Amherst, NY 14228 • USA  
**Tel:** 716.250.1900 • **Fax:** 716.250.1909  
**Email:** info@stellartech.com

ISO 9001:2000  
**STI**  
STELLAR TECHNOLOGY  
INCORPORATED